

# NPX

15D/17/20/22

ELECTRIC 24/36 VOLT  
3000 / 3500 / 4000 / 4500 lbs.  
(1350 / 1600 / 1800 / 2000 kg)



**CLARK**<sup>®</sup>



Rear posts add support to the overhead guard and help prevent objects from entering the operator compartment, helping to keep your employees as **safe** as possible.



## Reliable Performance with State of the Art Technology

The CLARK NPX 100% AC design, matched with energy-efficient components, delivers improved acceleration, travel and lifting speeds, increasing productivity. Operators have greater control to move product with more confidence. Reliable components require less service lowering overall costs.

# 65°

The NPX operator compartment and controls are designed with the operator standing at 65 degrees from center. This provides the widest range of flexibility and visual confirmation when traveling and handling loads to maximize productivity

Silent-staging upright helps to reduce shock and vibration. Nested I-beam rails provide strength and rigidity. Cylinder and hose routing design provides open field of vision improving operator confidence.

Maximum Visibility + Minimum Fatigue =  
**Increased Safety & Product Integrity**

The operator compartment is designed with comfort and productivity in mind. The contoured full-support backrest, padded armrest and tiller position are fully adjustable to customize the operator compartment reducing fatigue and maximizing productivity.

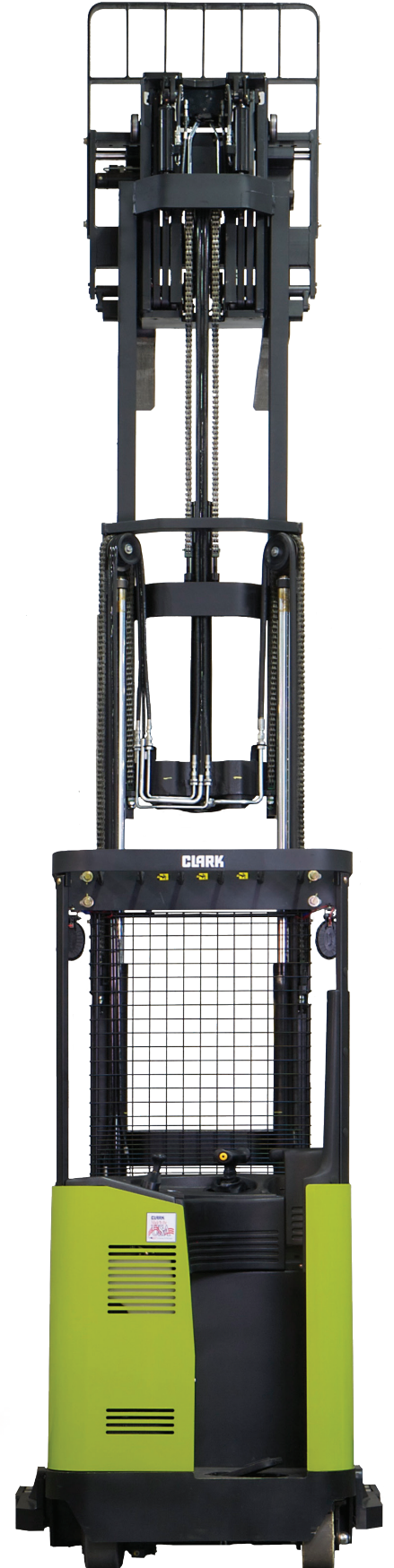

# NPX Performance and Safety in Mind

Rugged and reliable the new CLARK NPX series forklift trucks offer superior controllability, excellent front and rear visibility and high-speed operation to help increase productivity and profit while at the same time helping to improve operator safety. And maintenance has been made easier than ever. For increased performance, count on the CLARK NPX.



## NPX CAPACITY

NPX 15D 3,000 lbs

NPX 17 3,500 lbs

NPX 20 4,000 lbs

NPX 22 4,500 lbs

## STATE OF THE ART TECHNOLOGY

- Advanced 100% AC motors and controllers.
- Electro-mechanical brakes.
- Electronic speed-sensitive power steering.
- High efficiency hydraulic system.



## BRAKING

- Primary (electric) braking provided through electronic controller.
- Service brake engages automatically at zero travel.
- Electro-mechanical brake reduces components and complexity.
- Smooth, consistent braking in all load and travel conditions.

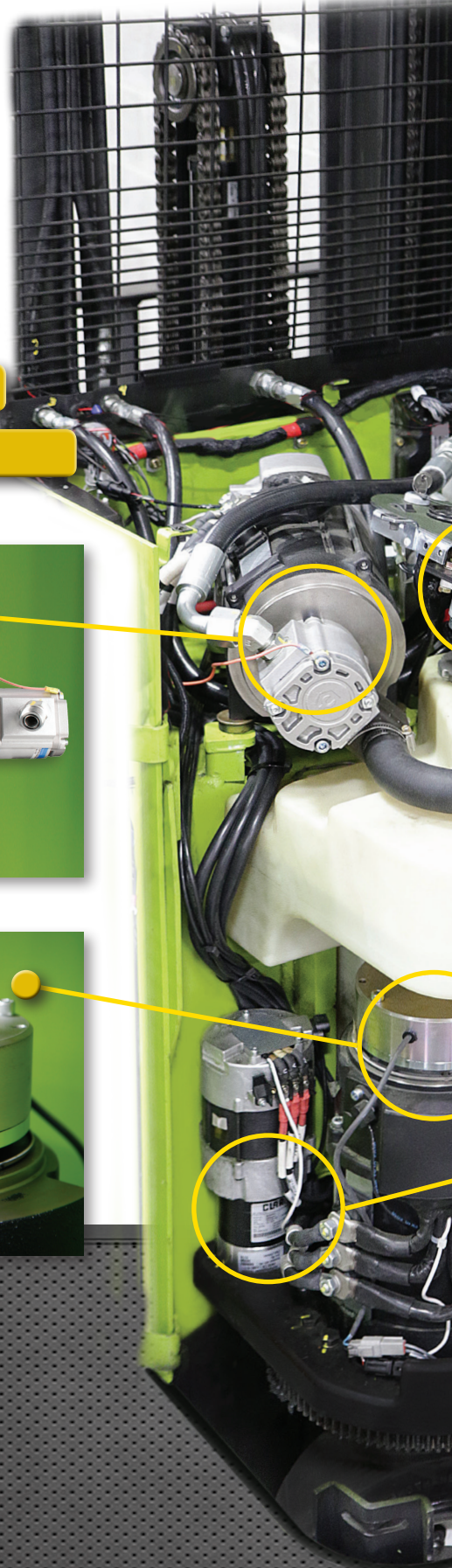

**CALL OR VISIT CLARK TO LEARN MORE ABOUT THE NPX SERIES**

North American Headquarters  
866-252-5275 • [www.clarkmhc.com](http://www.clarkmhc.com)

# Design and Testing

At CLARK Material Handling Co. we have learned from over one hundred years designing and building forklifts that they need to be designed from the ground up to be reliable. We perform extensive testing to ensure that our electric forklift trucks meet high environmental standards and provide reliable operation in most environments. Testing of components, subassemblies and complete products goes hand in hand with all phases of the design and production cycle.

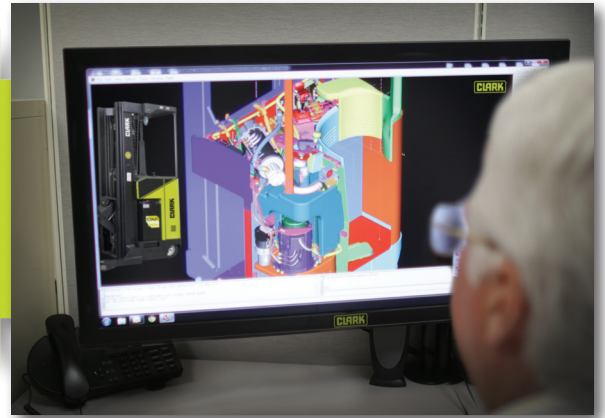

## TRUE MULTIFUNCTION CONTROL

### CLARK Designed Control Handle

- 3-Function design allows simultaneous operation of (1) travel, (2) lift or lower AND (3) one additional hydraulic function.

### Integrated Mini-Thumbstick

- Controls Tilt & Reach + Side Shift.

### Makes for One Smooth Operator

- Handle is 100% proportional using (solid state) Hall-effect components.
- Designed to fit a wide range of hand sizes and still give that "custom fit" feel for better ergonomics and less operator fatigue.

## ELECTRONIC STEERING

- Speed-sensitive steering provides optimal control when transporting or positioning loads.
- Self-centering function aligns drive wheel at key-on.
- Tiller can be placed in preferred position by individual operator.
- Quiet and energy efficient.

### Standard Equipment

- Key switch
- Load backrest extension
- Electronic horn
- Rear overhead guard post protection
- Heavy-duty battery rollers
- Battery retainers
- Lever type battery connect-disconnect
- Metal capacity plate

### Available Equipment

- Side shifter
- Freezer conditioning
- Reverse steering
- Travel alarms
- Strobe warning lights
- Operating lights
- U.L. Classified EE rating

# GENERAL DATA & STANDARD DIMENSIONS

## Upright Table

| Maximum Fork Height |      | Overall Height Lowered |      | Free Lift** |      |
|---------------------|------|------------------------|------|-------------|------|
| in                  | mm   | in                     | mm   | in          | mm   |
| <b>Triple Stage</b> |      |                        |      |             |      |
| 198                 | 5029 | 89                     | 2261 | 54          | 1372 |
| 210                 | 5334 | 95                     | 2413 | 60          | 1524 |
| 240                 | 6096 | 107                    | 2718 | 72          | 1829 |
| 258                 | 6553 | 113                    | 2870 | 78          | 1981 |
| 270                 | 6858 | 119                    | 3023 | 84          | 2134 |
| 300                 | 7620 | 131                    | 3327 | 96          | 2438 |
| 318                 | 8077 | 139                    | 3531 | 104         | 2642 |
| • 330               | 8382 | 149                    | 3785 | 114         | 2896 |
| • 366               | 9296 | 161                    | 4089 | 126         | 3200 |

For overall height raised with load backrest, add 48 in (1219 mm) to maximum fork height. Other uprights available, contact Clark representative. Uprights above 270" N/A on NPX17.

• NPX 15D, NPX 22 only.

## Carriage Widths\*/Fork Spread in(mm)

| Carriage Width |     | Fork Spread w/o Side Shifter |           | Fork Spread w/ Side Shifter |           |
|----------------|-----|------------------------------|-----------|-----------------------------|-----------|
| in             | mm  | max                          | min       | max                         | min       |
| 33             | 838 | 31.0(787)                    | 13.0(330) | 27.7(704)                   | 22.3(566) |
| 37             | 940 | 35.0(889)                    | 13.0(330) | 27.7(704)                   | 22.3(566) |

\* 37 in. wide carriages available with outrigger I.D. 38 in. and greater (40 in. and greater with 10.5 in. load wheels.)

## NPX Min. Right Angle Stack Aisle in(mm)\*

| Pallet or Load Size Length x Width | Battery Compartment (L) |            |             |             |
|------------------------------------|-------------------------|------------|-------------|-------------|
|                                    | 13.88(353)              | 16.13(410) | 18.5(470)** | 21.0(533)** |
| 36x30(914x762)                     | 82.2(2088)              | 84.1(2136) | 86.8(2205)  | 89.0(2261)  |
| 42x36(1067x914)                    | 87.1(2212)              | 89.2(2266) | 92.1(2339)  | 94.5(2400)  |
| 36x40(914x1016)                    | 82.0(2083)              | 83.9(2131) | 86.8(2205)  | 89.0(2261)  |
| 40x40(1016x1016)                   | 84.8(2154)              | 86.8(2205) | 89.6(2276)  | 91.9(2334)  |
| 48x40(1219x1016)                   | 93.0(2362)              | 95.1(2416) | 98.2(2494)  | 100.6(2555) |
| 48x42(1219x1067)                   | 92.8(2357)              | 94.9(2410) | 98.0(2489)  | 100.4(2550) |
| 48x44(1219x1118)                   | 92.6(2352)              | 94.7(2405) | 97.7(2482)  | 100.2(2545) |
| 48x48(1219x1219)                   | 92.2(2342)              | 94.3(2395) | 97.3(2471)  | 99.8(2535)  |

\* Add 6 to 8 inches clearance for ease of operation. Dimensions are based on 42 inch I.D. outrigger with 5 x 3.76 in. load wheels and 4" clearance each side of load.

\*\*Add 8" for NPX 15D (plus operating clearance).

## Outrigger Dimensions - I.D./O.D. (in)

| Dual 5 x 3.76 Load Wheels Toe Box Width 5.5 in |      | Dual 5 x 3.01 Load Wheels Toe Box Width 4.5 in |      | Single 10.5 x 4.5 Load Wheels Toe Box Width 6.0 in |       | Dual 4 x 2.62 Load Wheels Toe Box Width 4.5 in |      |
|--|------|--|------|--|-------|--|------|
| I.D.   | O.D. | I.D.   | O.D. | I.D.   | O.D.  | I.D.   | O.D. |
| 33   | 44   | 33   | 42   | -  | -     | 33   | 42   |
| 34   | 45   | 34   | 43   | -  | -     | 34   | 43   |
| 36   | 47   | 35   | 44   | 36.25  | 48.25 | 35   | 44   |
| 38   | 49   | 37   | 46   | 38.25  | 50.25 | 37   | 46   |
| 40   | 51   | 39   | 48   | 40.25  | 52.25 | 39   | 48   |
| 41   | 52   | 41   | 50   | 41.25  | 53.25 | 41   | 50   |
| 42   | 53   | 42   | 51   | 42.25  | 54.25 | 42   | 51   |
| 44   | 55   | 43   | 52   | 44.25  | 56.25 | 43   | 52   |
| 46   | 57   | 45   | 54   | 46.25  | 58.25 | 45   | 54   |
| 48   | 59   | 47   | 56   | 48.25  | 60.25 | 47   | 56   |
| 50   | 61   | 49   | 58   | 50.25  | 62.25 | 49   | 58   |
| -  | -    | 51   | 60   | -  | -     | 51   | 60   |

## Outrigger Dimensions - I.D./O.D. (mm)

| Dual 127 x 96 Load Wheels Toe Box Width 140mm |      | Dual 127 x 76 Load Wheels Toe Box Width 114mm |      | Single 267 x 114 Load Wheels Toe Box Width 152mm |      | Dual 102 x 67 Load Wheels Toe Box Width 114mm |      |
|---|------|---|------|--|------|---|------|
| I.D.  | O.D. | I.D.  | O.D. | I.D.   | O.D. | I.D.  | O.D. |
| 838   | 1118 | 838   | 1067 | -  | -    | 838   | 1067 |
| 864   | 1143 | 864   | 1092 | -  | -    | 864   | 1092 |
| 914   | 1194 | 889   | 1118 | 921  | 1226 | 889   | 1118 |
| 965   | 1245 | 940   | 1168 | 972  | 1276 | 940   | 1168 |
| 1016  | 1295 | 991   | 1219 | 1022   | 1327 | 991   | 1219 |
| 1041  | 1321 | 1041  | 1270 | 1048   | 1353 | 1041  | 1270 |
| 1067  | 1346 | 1067  | 1295 | 1073   | 1378 | 1067  | 1295 |
| 1118  | 1397 | 1092  | 1321 | 1124   | 1429 | 1092  | 1321 |
| 1168  | 1448 | 1143  | 1372 | 1175   | 1480 | 1143  | 1372 |
| 1219  | 1499 | 1194  | 1422 | 1226   | 1530 | 1194  | 1422 |
| 1270  | 1549 | 1245  | 1473 | 1276   | 1581 | 1245  | 1473 |
| -   | -    | 1295  | 1524 | -  | -    | 1295  | 1524 |

## Battery Weights & Compartment Dimensions

| Width (W) |     | Length (L) |     | Height (H) |     | Min. Weight |      |
|-----------|-----|------------|-----|------------|-----|-------------|------|
| in        | mm  | in         | mm  | in         | mm  | lbs.        | kg   |
| 38.75     | 984 | 13.88      | 353 | 32.0       | 813 | 1590        | 721  |
| 38.75     | 984 | 16.13      | 410 | 32.0       | 813 | 1885        | 855  |
| 38.75     | 984 | 18.50      | 470 | 32.0       | 813 | 2175        | 987  |
| 38.75     | 984 | 21.00      | 533 | 32.0       | 813 | 2460        | 1116 |

## Maximum Battery Size

| Width (W) |     | Length (L) |     | Height (H) |     |
|-----------|-----|------------|-----|------------|-----|
| in        | mm  | in         | mm  | in         | mm  |
| 38.69     | 983 | 13.50      | 343 | 31.5       | 800 |
| 38.69     | 983 | 15.75      | 400 | 31.5       | 800 |
| 38.69     | 983 | 18.00      | 457 | 31.5       | 800 |
| 38.69     | 983 | 20.50      | 521 | 31.5       | 800 |

## Operator Compartment/Overhead Guard Dimensions

| Maximum Fork Height |      | Compartment Inside |      | Overhead Guard Height |      |
|---------------------|------|--------------------|------|-----------------------|------|
| in                  | mm   | in                 | mm   | in                    | mm   |
| 198                 | 5029 | 75                 | 1905 | 89                    | 2261 |
| 210                 | 5334 | 81                 | 2057 | 95                    | 2413 |
| 240                 | 6096 | 81                 | 2057 | 95                    | 2413 |
| 258                 | 6553 | 81                 | 2057 | 95                    | 2413 |
| 270                 | 6858 | 81                 | 2057 | 95                    | 2413 |
| 300                 | 7620 | 81                 | 2057 | 95                    | 2413 |
| 318                 | 8077 | 81                 | 2057 | 95                    | 2413 |
| * 330               | 8382 | 81                 | 2057 | 95                    | 2413 |
| * 366               | 9296 | 81                 | 2057 | 95                    | 2413 |

\* NPX 15D, NPX 22 only.

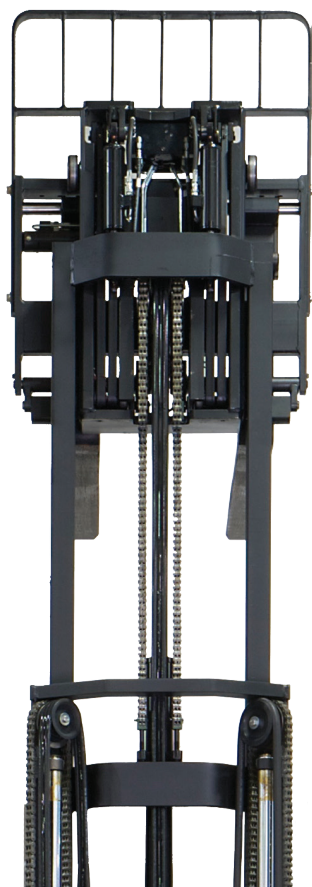

# STANDARD SPECIFICATIONS

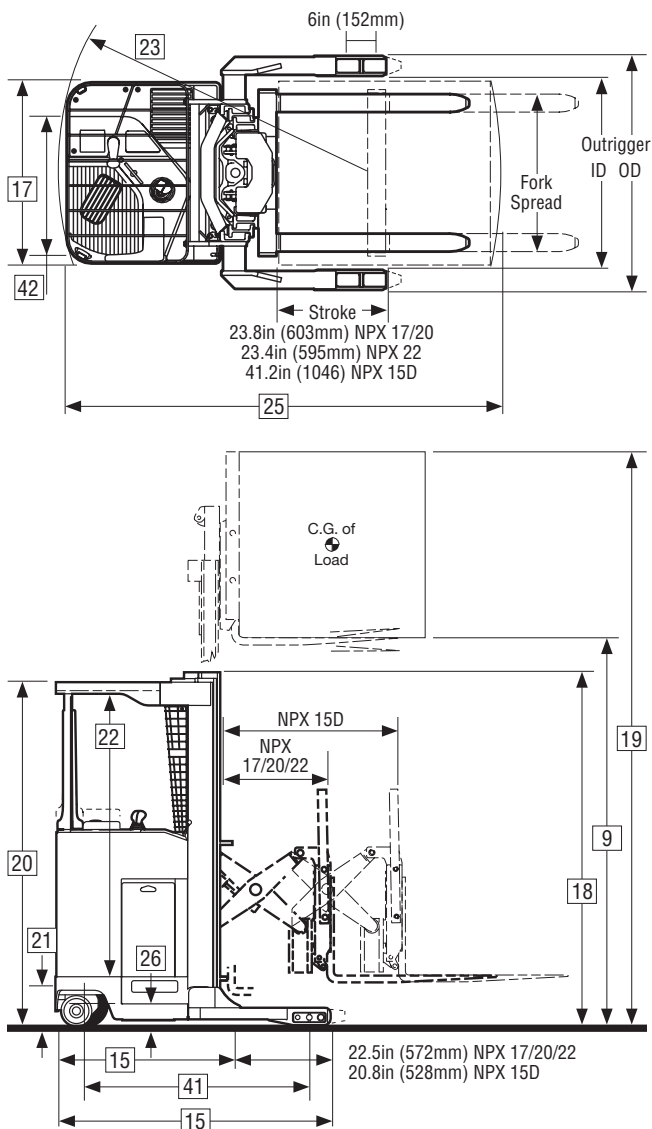

For corresponding data see Specification Chart

## ANSI/ITSDF and Insurance Classification

Standard truck meets all applicable mandatory requirements of Part III-ANSI/ITSDF B56.1 Safety Standard for Powered Industrial Trucks (latest edition at time of manufacture) and Underwriters Laboratories requirements as to fire and electrical shock hazard only for "E" classification. For further information contact a Clark representative.

Users should be aware of, and adhere to, applicable codes and regulations regarding operator training, use, operation and maintenance of powered industrial trucks, including:

- ANSI/ITSDF B56.1
- NFPA 505, fire safety standard for powered industrial trucks - type designations, areas of use, maintenance and operation.
- Occupational Safety and Health Administration (OSHA) regulations that may apply.

Contact your authorized CLARK forklift truck dealer for further information including operator training programs and auxiliary visual and audible warning systems, fire extinguishers, etc., as available for specific user applications and requirements.

Performance may vary +5% and -10% due to motor and systems efficiency tolerance. The performance shown represents nominal values which may be obtained under typical operating conditions of a standard machine.

Grade Clearance: The NPX is not designed for operation on or over grades. NPX is designed to operate on level ground only.

Specifications, equipment, technical data, photos and illustrations are based on information at time of printing and are subject to change without notice. Some products may be shown with optional equipment.

|                                 |                |                                      |  |          |
|---------------------------------|----------------|--------------------------------------|--|----------|
| General Information             | 1              | Manufacturer                         |  |          |
|                                 | 2              | Model                                | Manufacturer's Designation                   |          |
|                                 | 3              | Load Capacity                        |  | lbs(kg)  |
|                                 | 4              | Load Center                          | Fork Face to Load CG                         | in(mm)   |
|                                 | 5              | Power Unit                           | Electric                                     |          |
|                                 | 6              | Operator Type                        |  |          |
|                                 | 7              | Tire Type                            |  |          |
|                                 | 8              | Wheels (x=driven)                    | Front/Rear                                   |          |
| Basic Dimensions <sup>1,2</sup> | 9              |                                      |  |          |
|                                 | 10             | Upright <sup>3</sup>                 | Lift Height (Preferred Upright)              | in(mm)   |
|                                 | 11             |                                      | Freelift                                     | in(mm)   |
|                                 | 12             | Fork Tilt                            | Back/Forward                                 | degrees  |
|                                 | 13             | Fork                                 | Std. Fork Size (T x W x L)                   | in(mm)   |
|                                 | 14             | Carriage                             | Width of Carriage                            | in(mm)   |
|                                 | 15             | Overall Dimensions                   | Length to Fork Face                          | in(mm)   |
|                                 |                |                                      | Overall length, less forks                   | in(mm)   |
|                                 | 16             |                                      | Outrigger ID/OD                              | in(mm)   |
|                                 | 17             |                                      | Frame Width                                  | in(mm)   |
|                                 | 18             |                                      | Height, Upright Lowered                      | in(mm)   |
|                                 | 19             |                                      | Height, Upright Extended                     | in(mm)   |
|                                 | 20             |                                      | Height, Overhead Guard                       | in(mm)   |
|                                 | 21             | Step Height                          | Ground to Top of Floor Plate                 | in(mm)   |
|                                 | 22             | Head Clearance                       | Top of Floor Plate to Bottom of OHG          | in(mm)   |
| 23                              | Turning Radius |                                      | in(mm)                                       |          |
| 24                              |                |                                      |  |          |
| Performance                     | 25             | Right Angle Stack Aisle <sup>4</sup> | 48 in x 40 in pallet                         | in(mm)   |
|                                 | 26             | Battery Compartment                  | W x L x H                                    | in(mm)   |
|                                 |                | Battery Roller Height                | Ground to Top of Rollers                     | in(mm)   |
|                                 | 27             | Stability                            | According to ANSI                            |          |
|                                 | 28             | Speeds- Forks Trailing               | Travel Speed, Max, With Load <sup>5</sup>    | mph(kph) |
|                                 | 29             |                                      | Travel Speed, Max, Without Load <sup>5</sup> | mph(kph) |
| Weights <sup>2</sup>            | 30             |                                      | Lift Speeds, Loaded                          | fpm(mps) |
|                                 | 31             |                                      | Lift Speeds, Unloaded                        | fpm(mps) |
|                                 | 32             |                                      | Lower Speeds, Loaded                         | fpm(mps) |
|                                 | 33             |                                      | Lower Speeds, Unloaded                       | fpm(mps) |
|                                 | 34             | Service Weight, TSU                  | W/Min Battery Weight                         | lbs(kg)  |
|                                 | 35             | Axle loading                         | With Load, Front                             | lbs(kg)  |
| Chassis                         | 36             |                                      | With Load, Rear                              | lbs(kg)  |
|                                 | 37             |                                      | W/O Load, Front                              | lbs(kg)  |
|                                 | 38             |                                      | W/O Load, Rear                               | lbs(kg)  |
|                                 | 39             | Tires/Wheels                         | Number, Front/Rear                           |          |
|                                 | 40             |                                      | Size, Load Wheels                            | in(mm)   |
|                                 |                |                                      | Size, Rear Drive/Steer                       | in(mm)   |
|                                 |                |                                      | Size, Rear Caster                            | in(mm)   |
| Drive Line                      | 41             | Wheelbase                            |  | in(mm)   |
|                                 | 42             | Track                                | Rear   | in(mm)   |
|                                 | 43             |                                      |  |          |
|                                 | 44             | Ground Clearance                     | With 5 in diameter load wheels               | in(mm)   |
|                                 | 45             |                                      |  |          |
|                                 | 46             | Service Brake                        | Type   |          |
|                                 | 47             | Parking Brake                        | Type   |          |
| Drive Line                      |                | Steering                             | Type   |          |
|                                 | 48             | Battery                              | Type   |          |
|                                 |                |                                      | Max Capacity (6 hr. Rate) 24V/36V            | kWh      |
|                                 |                |                                      | Weight, Min                                  | lbs(kg)  |
|                                 | 49             | Motors, Controls                     | Drive Motor, Diameter                        | in(mm)   |
|                                 |                |                                      | Hydraulic Motor, Diameter                    | in(mm)   |
|                                 |                |                                      | Steer Motor, diameter                        | in(mm)   |
|                                 |                | Drive Motor Control                  | Type   |          |
|                                 |                | Speed Control                        | Type   |          |
|                                 |                | Hydraulic Motor Control              | Type   |          |
|                                 |                | Steer Motor Control                  | Type   |          |

- Notes: 1 Specifications are for truck with tandem 5 in (127 mm) diameter x 3.76 in (96mm) wide load wheels. Other sizes are also available.  
 2 Specifications are for truck with 210 in (5334 mm) MFH upright, 42 in (1067 mm) outrigger ID and 33 in (838 mm) sideshifter (deduct 50 lb. (23kg) for weight less SS). Battery compartment dimensions as noted.  
 3 See Upright Table for other available uprights.

| CLARK<br>NPX17                               | CLARK<br>NPX20                               | CLARK<br>NPX22                               | CLARK<br>NPX15D                              |
|--|--|--|--|
| 3500 (1600)                                  | 4000 (1800)                                  | 4500 (2000)                                  | 3000 (1350)                                  |
| 24 (600)                                     | 24 (600)                                     | 24 (600)                                     | 24 (600)                                     |
| Dual 24 volt / 36 volt                       | Dual 24 volt / 36 volt                       | 36 volt                                      | 36 volt                                      |
| Rider Reach                                  | Rider Reach                                  | Rider Reach                                  | Rider Double Reach                           |
| Solid  | Solid  | Solid  | Solid  |
| 4/2 (1x)                                     | 4/2 (1x)                                     | 4/2 (1x)                                     | 4/2 (1x)                                     |
| 210 (5334)                                   | 210 (5334)                                   | 210 (5334)                                   | 210 (5334)                                   |
| 60 (1524)                                    | 60 (1524)                                    | 60 (1524)                                    | 60 (1524)                                    |
| 4/3  | 4/3  | 4/3  | 4/3  |
| 1.75 x 4 x 42 (44 x 102 x 1067)              | 1.75 x 4 x 42 (44 x 102 x 1067)              | 1.75 x 4 x 42 (44 x 102 x 1067)              | 1.75 x 4 x 42 (44 x 102 x 1067)              |
| 33 (838)                                     | 33 (838)                                     | 33 (838)                                     | 33 (838)                                     |
| 48.1 (1222)                                  | 48.1 (1222)                                  | 51.1 (1298)                                  | 61.0 (1550)                                  |
| 70.25 (1784)                                 | 70.25 (1784)                                 | 75.9 (1928)                                  | 81.8 (2078)                                  |
| See Outrigger Dimension Chart                | See Outrigger Dimension Chart                | See Outrigger Dimension Chart                | See Outrigger Dimension Chart                |
| 40.25 (1022)                                 | 40.25 (1022)                                 | 40.25 (1022)                                 | 40.25 (1022)                                 |
| 95 (2413)                                    | 95 (2413)                                    | 95 (2413)                                    | 95 (2413)                                    |
| 258 (6553)                                   | 258 (6553)                                   | 258 (6553)                                   | 258 (6553)                                   |
| 95 (2413)                                    | 95 (2413)                                    | 95 (2413)                                    | 95 (2413)                                    |
| 12.2 (310)                                   | 12.2 (310)                                   | 12.2 (310)                                   | 12.2 (310)                                   |
| 81 (2057)                                    | 81 (2057)                                    | 81 (2057)                                    | 81 (2057)                                    |
| 66.5 (1689)                                  | 66.5 (1689)                                  | 69.7 (1770)                                  | 76.14 (1934)                                 |
| 93 (2362)                                    | 93 (2362)                                    | 98.2 (2494)                                  | 106 (2692)                                   |
| 38.75x13.88x32 (984x353x813)                 | 38.75x13.88x32 (984x353x813)                 | 38.75x18.5x32 (984x470x813)                  | 38.75x18.5x32 (984x470x813)                  |
| 6.25 (159)                                   | 6.25 (159)                                   | 6.25 (159)                                   | 6.25 (159)                                   |
| Yes  | Yes  | Yes  | Yes  |
| 6.8 (10.9) / 7.5 (12.0)                      | 6.6 (10.6) / 7.5 (12.0)                      | 7.5 (12.0)                                   | 7.5 (12.0)                                   |
| 7.5 (12.0) / 7.5 (12.0)                      | 7.5 (12.0) / 7.5 (12.0)                      | 7.5 (12.0)                                   | 7.5 (12.0)                                   |
| 69 (.35) / 98 (.50)                          | 67 (.34) / 92 (.47)                          | 77 (0.39)                                    | 105 (0.53)                                   |
| 115 (.58) / 130 (.66)                        | 115 (.58) / 130 (.66)                        | 130 (0.66)                                   | 130 (0.66)                                   |
| 105 (.53)                                    | 105 (.53)                                    | 105 (.53)                                    | 105 (.53)                                    |
| 95 (.48)                                     | 95 (.48)                                     | 95 (.48)                                     | 95 (.48)                                     |
| 6620 (3002)                                  | 6900 (3129)                                  | 7988 (3623)                                  | 8367 (3795)                                  |
| 6402 (2903)                                  | 7025 (3186)                                  | 8274 (3752)                                  | 6714 (3045)                                  |
| 3718 (1686)                                  | 3875 (1757)                                  | 4214 (1911)                                  | 4653 (2110)                                  |
| 2570 (1166)                                  | 2645 (1200)                                  | 3091 (1402)                                  | 3259 (1478)                                  |
| 4050 (1837)                                  | 4255 (1930)                                  | 4897 (2221)                                  | 5108 (2317)                                  |
| 4/2  | 4/2  | 4/2  | 4/2  |
| (4) 5 x 3.76 urethane (127x96)               | (4) 5 x 3.76 urethane (127x96)               | (4) 5 x 3.76 urethane (127x96)               | (4) 5 x 3.76 urethane (127x96)               |
| 13.5 x 5.5 rubber (343 x 140)                | 13.5 x 5.5 rubber (343 x 140)                | 13.0 x 5.5 urethane (330 x 140)              | 13.0 x 5.5 urethane (330 x 140)              |
| 8 x 4 urethane (203 x 102)                   | 8 x 4 urethane (203 x 102)                   | 8 x 4 urethane (203 x 102)                   | 8 x 4 urethane (203 x 102)                   |
| 56.1 (1425)                                  | 56.1 (1425)                                  | 61.7 (1567)                                  | 65.75 (1670)                                 |
| 28.7 (729)                                   | 28.7 (729)                                   | 28.7 (729)                                   | 28.7 (729)                                   |
| 1.75 (44)                                    | 1.75 (44)                                    | 1.75 (44)                                    | 1.75 (44)                                    |
| Regenerative<br>Auto-Electro-Magnetic        | Regenerative<br>Auto-Electro-Magnetic        | Regenerative<br>Auto-Electro-Magnetic        | Regenerative<br>Auto-Electro-Magnetic        |
| Power  | Power  | Power  | Power  |
| Lead-Acid                                    | Lead-Acid                                    | Lead-Acid                                    | Lead-Acid                                    |
| 28.9 / 27.0                                  | 28.9 / 27.0                                  | 37.6   | 37.6   |
| 1590 (722)                                   | 1590 (722)                                   | 2175 (987)                                   | 2175 (987)                                   |
| 7.9 (200)                                    | 7.9 (200)                                    | 7.9 (200)                                    | 7.9 (200)                                    |
| 6.7 (170)                                    | 6.7 (170)                                    | 6.7 (170)                                    | 6.7 (170)                                    |
| 4.2 (106.5)                                  | 4.2 (106.5)                                  | 4.2 (106.5)                                  | 4.2 (106.5)                                  |
| AC Induction Motor Controller<br>Solid State | AC Induction Motor Controller<br>Solid State | AC Induction Motor Controller<br>Solid State | AC Induction Motor Controller<br>Solid State |
| AC Induction Motor Controller                | AC Induction Motor Controller                | AC Induction Motor Controller                | AC Induction Motor Controller                |
| AC Induction Motor Controller                | AC Induction Motor Controller                | AC Induction Motor Controller                | AC Induction Motor Controller                |

4 Right angle stacking aisle for pallet size shown. Add 6-8 in (152-203 mm) for operating clearance. See "General Data" for other pallet sizes.

5 Travel speed reduced to 6.75 mph (10.8 kph) when traveling forks leading.



## ***& Don't Forget...*** **Safety Starts With You!**

### **Before operating a lift truck, an operator must:**

- Be trained and authorized
- Read and understand operator's manual
- Not operate a faulty lift truck
- Not repair a lift truck unless trained and authorized
- Have the overhead guard and load backrest extension in place
- Perform daily inspections

### **During operation, a lift truck operator must:**

- Keep feet, legs and all parts of body inside operator compartment
- Never carry passengers or lift people
- Keep truck away from people and obstructions
- Travel with lift mechanism as low as possible and tilted back
- Allow safe stopping distance and come to a complete stop before leaving operator compartment

### **To park a lift truck, an operator must:**

- Completely lower forks or attachments
- Turn key off

- We don't just build forklifts. As a company, we are also focused on providing our customers with the best possible technical service support and aftermarket parts available.
- Even though our business starts with a quality, cost-effective product, our organization understands that it is the support and services we provide after the sale that help keep your business running at peak efficiency.
- **THE CLARK PartsPRO Plus® SYSTEM** is our industry-leading electronic parts and service documentation tool that provides dealers with a quick and accurate method of identifying parts for every CLARK forklift built since 1961. PartsPRO® ensures the availability of the most current technical information and has the unique capability to create parts manuals specific to your mixed CLARK fleet, making it simple to positively identify and order the correct part(s) from your local CLARK dealer. The right CLARK part — The First Time, Every Time.
- **UNRIVALED PARTS SUPPORT** Our Aftermarket Distribution Center provides parts to over 250 North American CLARK dealer locations and many international dealers. This CLARK operated 184,000 square foot facility is dedicated to supporting the CLARK models built over the last 90 years. This facility is focused on providing excellent off-the-shelf availability, quality parts, quick response time and competitive pricing.

## **DEPENDABLE PARTS = DEPENDABLE TRUCKS**

To Find Your Nearest Authorized CLARK Dealer, Visit Our Website [www.clarkmhc.com](http://www.clarkmhc.com)



# BUILT TO LAST.®



**CLARK MATERIAL HANDLING COMPANY**  
 North American Headquarters  
 700 Enterprise Drive • Lexington, KY 40510  
 866-252-5275 • [www.clarkmhc.com](http://www.clarkmhc.com)

**NPX15D/17/20/22**  
 59-894-1055 Printed in USA MP03155M

© 2015 CLARK Material Handling Company